

Personal Viewing System (PVS) Assembly Guide

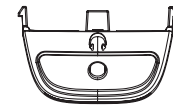
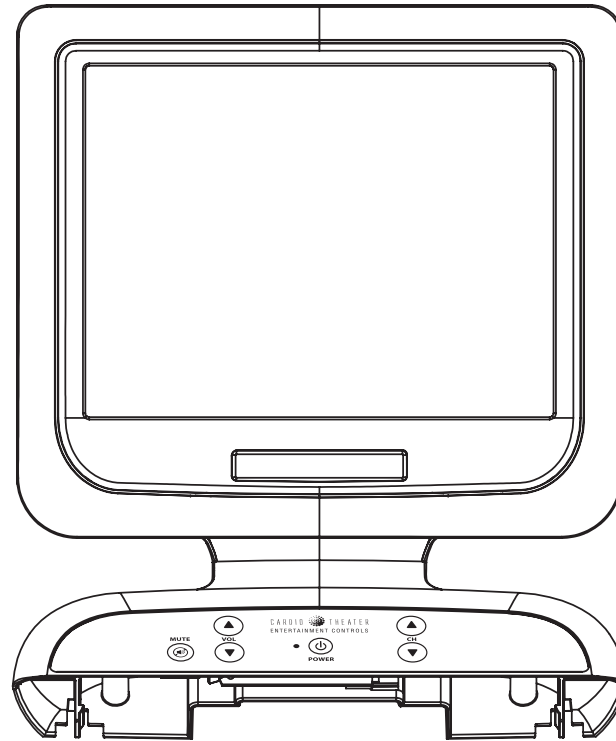

Important Safety Instructions

When using exercise equipment, basic precautions should always be taken, including the following:

- Read all instructions before using the Personal Viewing System (PVS). These instructions are written for your safety and to protect the equipment.
- Use the PVS only for its intended purpose. Do not use accessory attachments that are not recommended by the manufacturer, as such attachments might cause injuries.
- Always check the PVS and exercise equipment before each use. Make sure that all fasteners and cables are secure and in good working condition.

Important: *The important safety instructions written here reflect a portion of what is found in the Precor® Product Owner's Manuals and User's Reference Guides. Please review and follow the safety instructions found there. If you do not assemble the PVS Entertainment Option according to these instructions, you could void the Limited Warranty.*

Radio Frequency Interference (RFI)

Federal Communications Commission, Part 15

WARNING: To prevent fire or electrical shock, do not expose this equipment to rain, moisture or excess heat.

The unit has been tested and found to comply with the limits for Part 15 of the FCC Rules. These limits are designed to provide reasonable protection against harmful interference when the equipment is operated in a commercial environment.

The equipment generates, uses, and can radiate radio frequency energy and, if not installed and used in accordance with the assembly, installation and maintenance instruction manuals, may cause harmful interference to radio communications.

However, there is no guarantee that interference will not occur in a particular installation. If the unit does cause harmful interference to radio or television reception, which can be determined by turning the equipment off and on, the user is encouraged to try to correct the interference by one or more of the following measures:

- Reorient or relocate the receiving antenna.
- Increase the separation between the equipment and the receiver.
- Connect the equipment into a separate outlet that uses a different circuit than the receiver.

Consult a Radio Technician or an experienced radio/TV technician for help.

WARNING: Per FCC rules, changes or modifications not expressly approved by Cardio Theater could void the user's authority to operate the equipment.

Canadian Department of Communications

The equipment does not exceed the Class A limits for radio noise emissions from a digital apparatus set out in the Radio Interference Regulations of the Canadian Department of Communications.

Le présent appareil numérique n'émet pas de bruits radioélectriques dépassant les limites applicables aux appareils numériques de la class A prescrites dans le Règlement sur le brouillage radioélectrique édicté par le ministère des Communications du Canada.

Table of Contents

Important Safety Instructions	1	Precor EFX Assembly Steps	12
Radio Frequency Interference (RFI)	1	Install the Cables	13
Federal Communications Commission, Part 15	1	Attach the Entertainment Option	15
Canadian Department of Communications	1	Install the Screen	17
Before You Begin	3	Test the PVS	18
Review Precor Equipment Assembly Instructions	3	Precor Treadmill Assembly Steps	19
Installation Requirements	3	Install the Cables and Bracket	20
Unpacking the Equipment	3	Attach the Entertainment Option	21
Required Tools	3	Install the Screen	22
Obtaining Service	4	Install the Headphone	23
Precor Climber Assembly Steps	5	Test the PVS	24
Install the Cables	6	Precor Cycle Assembly Steps	25
Attach the Entertainment Option	8	Install the Cables	26
Install the Screen	10	Attach the Entertainment Option	27
Test the PVS	11	Install the Screen	29
		Test the PVS	30

Before You Begin

Thank you for adding the Personal Viewing System (PVS) to your Precor purchase. For proper installation, please read this guide thoroughly and follow the assembly instructions.

Important: *If you have designed the club facility layout with the PVS in mind, the following instructions provide what you need to integrate the Precor unit with the PVS assembly.*

Review Precor Equipment Assembly Instructions

If the PVS Entertainment Option and the Precor units are to be assembled on the same day, be sure to review the Precor assembly instructions that accompany each unit. Alleviate additional assembly or disassembly steps by combining the PVS and Precor unit assemblies as needed.

Installation Requirements

Review these installation requirements before assembly:

- Provide ample space around the unit. Open space around the unit allows for easier access and installation.
- Open the box and assemble components in the sequence presented in this guide. Refer to both assembly guides that accompany the PVS Entertainment Option and the Precor unit.
- Read all the instructions on each page.
- While you may be able to assemble the PVS Entertainment Option using the illustrations only, important safety notes and other tips are included in the text. Some illustrations show a generic view because of the similar assemblies across several Precor products.

The assembly of the PVS Entertainment Option takes about 1/2 hour to complete.

Unpacking the Equipment

The PVS Entertainment Option is shipped in one box with the following items:

- Screen
- Bracket
- Eight black buttonhead screws
- Integrated controller (5-wire, stereo plug, and RJ45 cables attached)
- Transition cover
- Headphone jack
- Fifteen foot coaxial/power cable (audio/video and power cable)
- Power module and extension cable

If any items are missing, contact the dealer from whom you purchased the unit or contact Cardio Theater Technical Support.

Required Tools

- Standard set of hex keys
- Phillips-head screwdriver
- Flathead screwdriver (treadmill assembly only)
- Needle nose pliers
- Roll of electrical tape
- Step stool

Obtaining Service

For information about product operation or service, refer to the Cardio Theater web site at www.cardiotheater.com or contact an authorized Cardio Theater Technical Support Representative at 1-800-776-6695 or service@cardiotheater.com. Representatives are available to serve you from 6:00 am to 5:00 pm, Monday through Friday, U.S.A. Pacific Time.

Should you need more information regarding customer support numbers for Precor equipment, or a list of authorized service centers, visit the Precor web site at www.precor.com/corp/contact.

Returning Equipment to Cardio Theater

To return equipment to Cardio Theater for any reason, you must contact Cardio Theater Technical Support and obtain a return authorization (RMA) number. When requesting the RMA number, explain why you are returning the equipment, for example you ordered too many controllers and the extra controller can be returned to stock, or the equipment needs repairs.

Important: *Equipment must be shipped with an RMA number in order for Cardio Theater to process it. Any equipment received without an RMA number will be returned to the sender.*

Precor Climber Assembly Steps

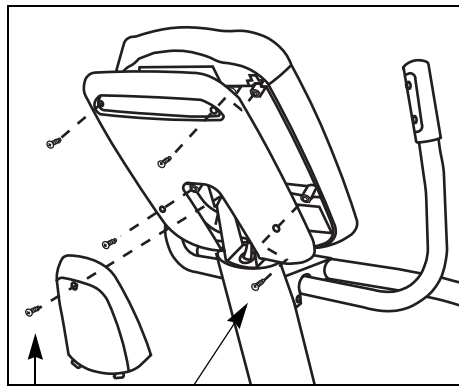

1

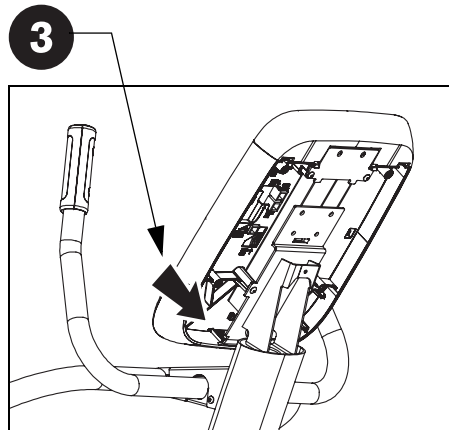

3

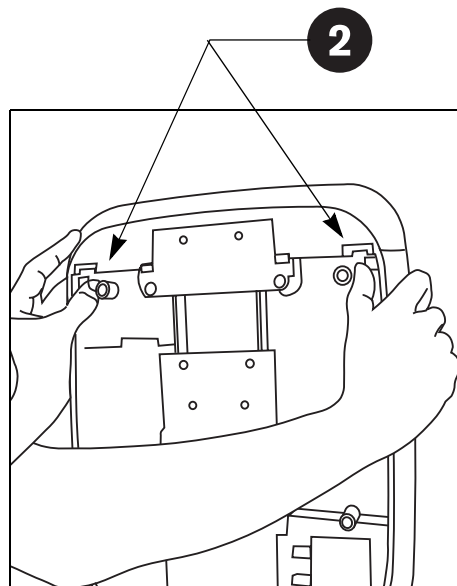

2

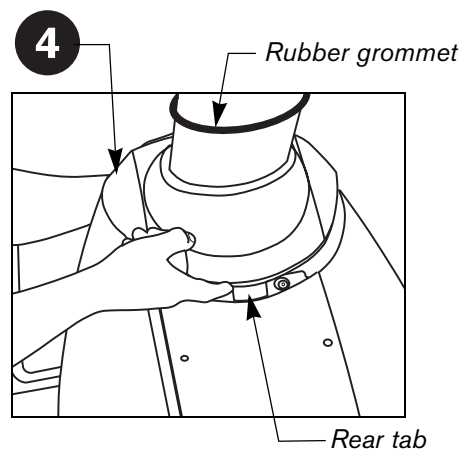

4

To expose the wiring and connections inside the display console and install the PVS, you need to take the following steps:

- 1 Use a Phillips-head screwdriver to remove the one screw that secures the neck cover and the four screws that secure the back console plate. Set the fasteners, neck cover, and back console plate aside.
- 2 Remove the entertainment option cover. Tabs exist on either side of the cover. Press the tabs to release the cover. You can discard the entertainment option cover.
Important: If you are replacing the integrated receiver, disconnect the 5-wire cable from the display console, and then pull the stereo plug (audio cable) out of the cover before removing and discarding the cover.
- 3 At the base of the display console, remove the audio cover. Place a finger inside the audio cover to push it out of the display console. You can discard the audio cover because it is replaced with the headphone jack.
- 4 Slide the rubber grommet and the plastic top cover along the upright support to expose the hole that the existing RJ45 cable feeds through.

Note: Push the rear tab in on the plastic top cover to unlock it before lifting it. You may need to detach the rubber grommet from the plastic top cover before sliding both along the upright support.

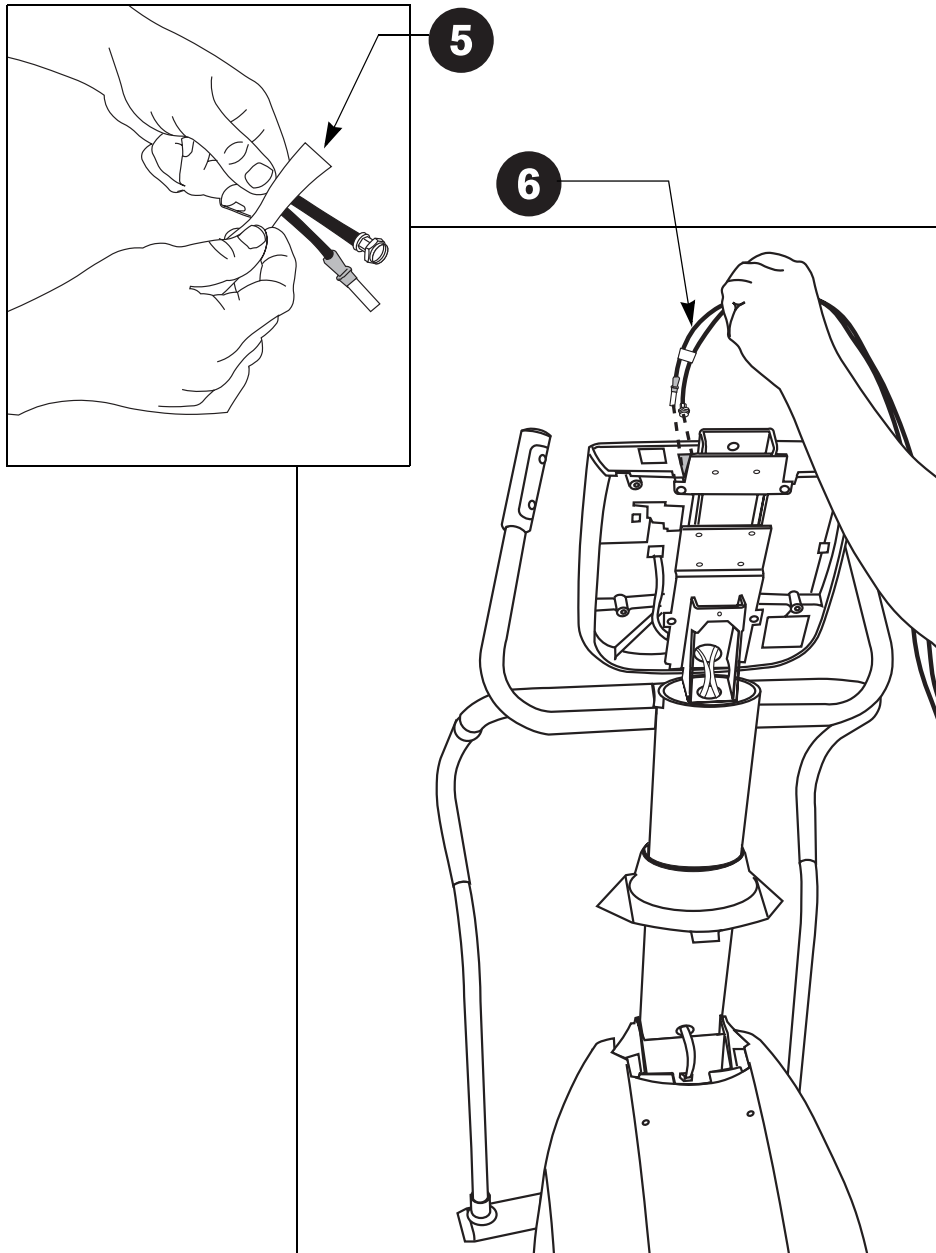

Install the Cables

- 5** To make it easier to feed the cables through the unit, tape the ends of the cables together (the female coaxial connection to the power cable). Refer to the illustration.

CAUTION: Be careful that you do not jostle or damage the heart rate electronics board on the inside of the display console. Cable connections can become dislodged which will impair the heart rate and upper display functions.

- 6** Feed the taped cable ends through the top of the display console and continue to feed the taped cable ends through the neck tube.

Note: Leave about 1 foot (30 cm) of cables hanging out of the upper portion of the display console. The coaxial and power connections will be attached to the back of the screen.

Important: Make sure that the cables are not pinched between the bracket and the display console.

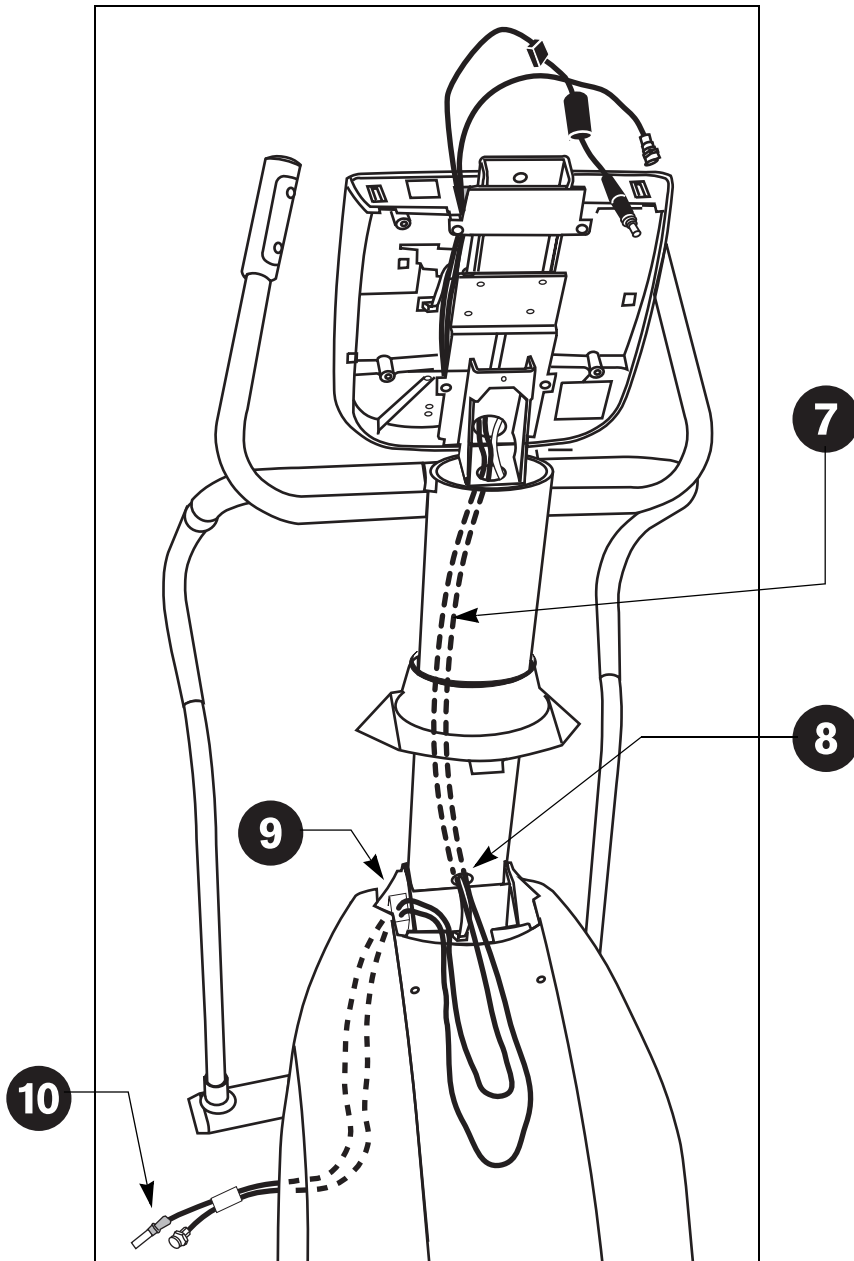

- 7** Continue to feed the taped cables down through the upright support, following the same route as the existing RJ45 cable.
- 8** Pull the taped cables out of the hole at the base of the upright.
Note: You may need to use needle nose pliers to gently pull the cable connectors out the small opening.
- 9** Feed the taped cables and its connectors into the internal upright frame tube and out onto the floor.
Note: You may need to ask for assistance to tip the unit on its side. Obtaining assistance and slightly tipping the unit may make it easier to gain access to the cables.
- 10** Pull the taped cables out from the base of the unit.

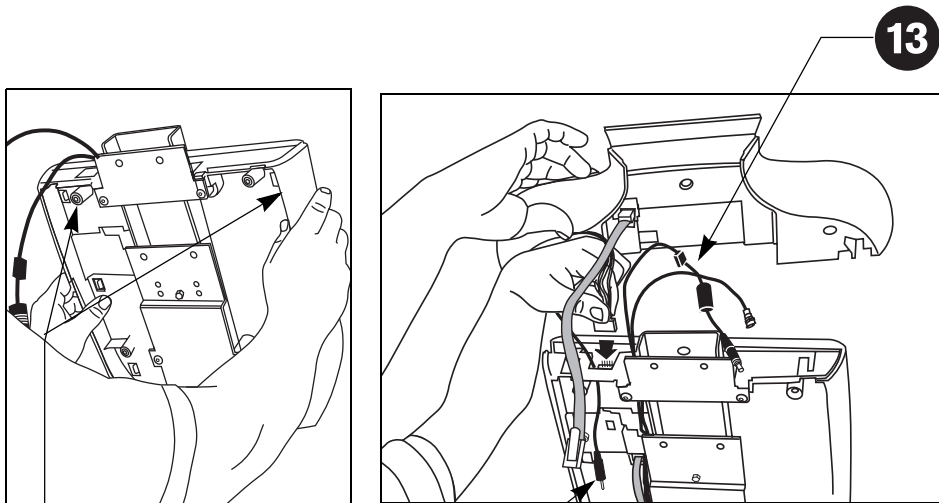

11 Top two tabs

12

13

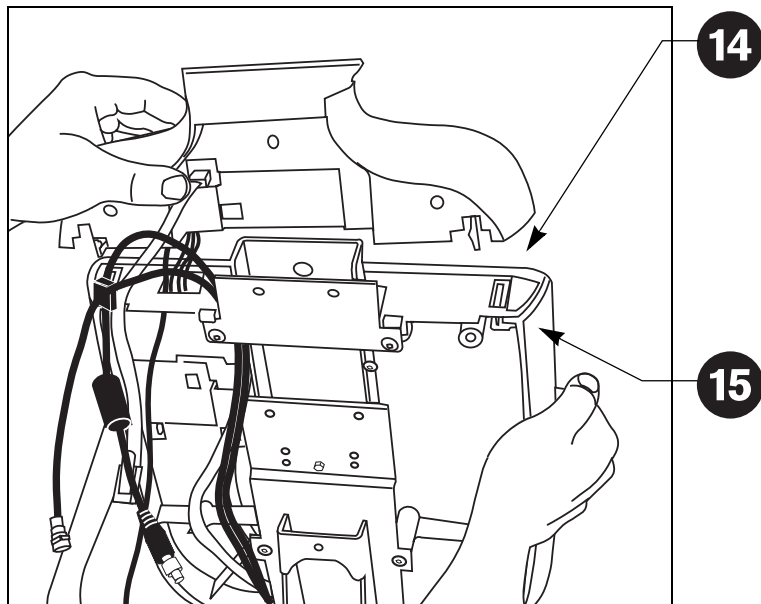

14

15

Attach the Entertainment Option

CAUTION: Do not try to access the tab found beneath the heart rate electronics board.

- 11** Separate the display console face from the console. Start at the top and work toward the bottom, pressing the five tabs to release it. This provides easier access to the 5-pin connector.
- 12** Hold the integrated controller above the display console and feed the audio cable through the opening in the base of the display console. Let the audio cable hang loose.

CAUTION: It is critical that you attach the red wire on the 5-wire entertainment option cable to Pin 1. The word, PIN 1, is inscribed on the back of the display console. An arrow points to the location of Pin 1. The connector is keyed so it will only connect one way. Do not force the connection.

- 13** Connect the 5-wire entertainment option cable to the display console.
- 14** Reattach the display console face by aligning the tabs and applying pressure to the display face.
- 15** Install the integrated controller by aligning the two tabs and applying pressure. Arrange the cables so you do not inadvertently pinch or damage the cables.

Important: Cable damaged by improper installation will not be covered by the Limited Warranty.

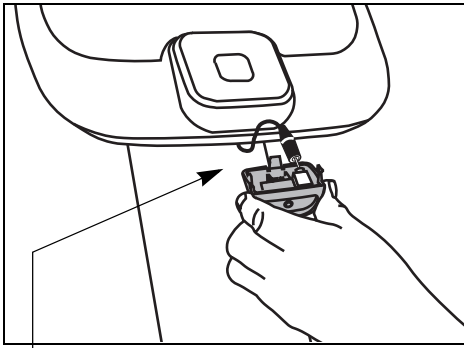

16

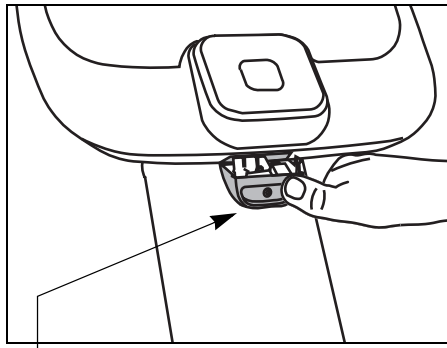

17

- 16 Feed the audio cable through the base of the display console and attach it to the headphone jack.
- 17 Insert the headphone jack into the base of the display console. Snap the headphone jack into place by positioning the rear tab first, and then applying pressure to the base.
- 18 Hold the cables out of the way as you slide the bracket into position and align the four mounting holes. Insert four black buttonhead screws and wrench tighten using a $\frac{5}{32}$ -inch hex key.
- 19 Attach the transition cover. Insert the base of the cover first and apply pressure to the upper portion. It should easily snap it into place.

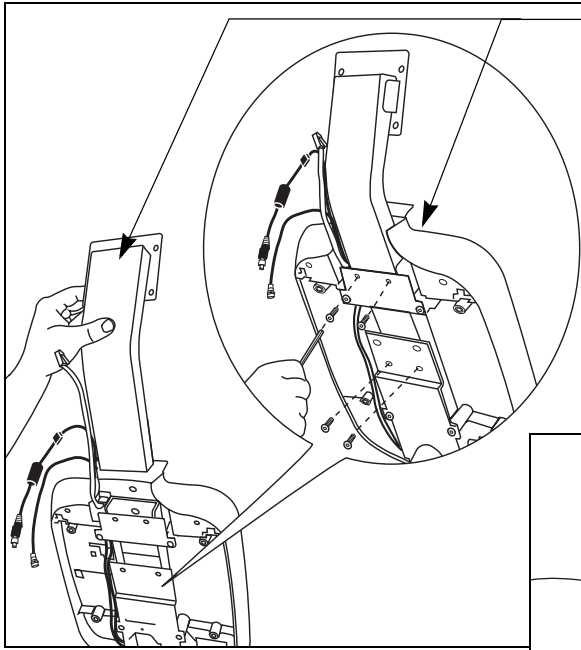

18

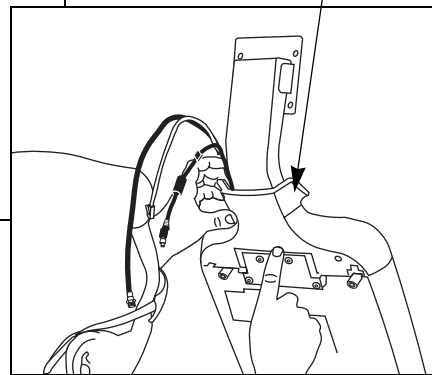

19

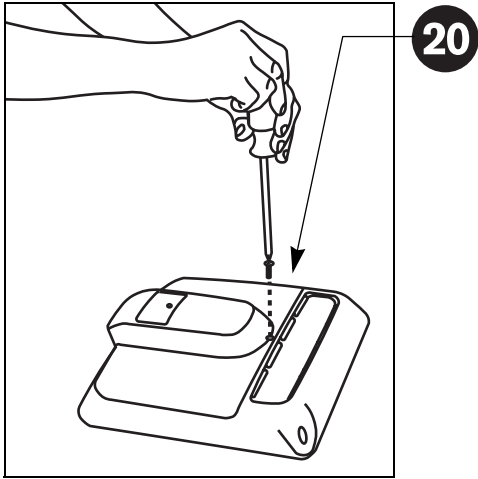

20

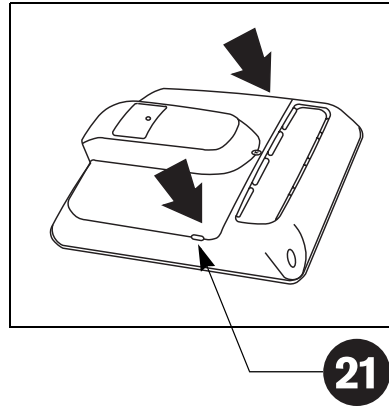

21

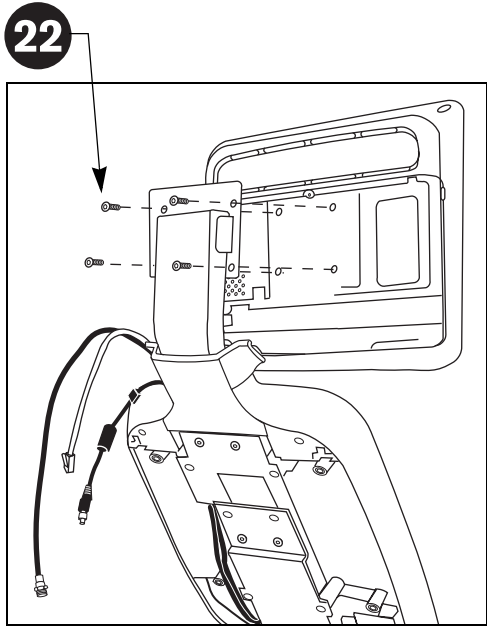

22

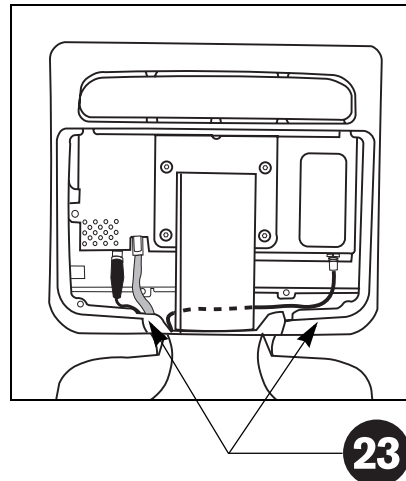

23

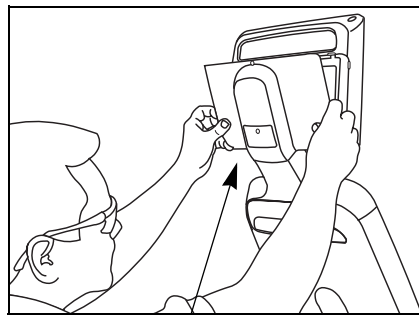

24

Install the Screen

- 20 Place the screen face down on a clean work surface so you have easy access to the back plate. Use a Phillips-head screwdriver to remove the one screw on the back plate.
 - 21 Place your fingers in the finger tabs on opposite sides of the back plate and pull up to remove the back plate. Set the fastener and back plate aside.
 - 22 Move the cables out of the way as you attach the screen to the bracket using four buttonhead screws. Finger tighten and then wrench tighten using a $\frac{5}{32}$ -inch hex key.
 - 23 Plug the RJ45 cable into the back of the screen. Feed the coaxial cable between the back of the screen and the bracket. Connect both the power and coaxial cables to the proper receptacles. Turn the ends of the coaxial and power connectors to properly secure the cables.
 - 24 Replace the back plate. Insert the base tabs first and then, apply pressure to engage the side tabs. Replace the Phillips-head screw. Refer to the illustration for step 20.
- Note:** You may want to test the PVS before replacing the back plate. In this case, perform steps 26 and 27 and then return to steps 24 and 25 to complete the PVS assembly.
- 25 Reassemble the display console by using a Phillips-head screwdriver to reattach the back console plate (four screws) and neck cover (one screw) removed in step 1. Refer to the illustration for step 1.

Test the PVS

- 26 At the base of the climber, plug the power cable in to the power extension module and connect it, along with the coaxial cable, into the appropriate Cardio Theater equipment connections.
- 27 Observe whether the PVS (screen and integrated controller) is receiving power while you configure the channels using the integrated controller and check the audio connection. For instructions on how to configure channels and troubleshoot the PVS, refer to the *PVS Operation and Maintenance Guide* provided in the box.

Note: A green LED illuminates on the integrated controller when it is connected to a power source.

Precor EFX Assembly Steps

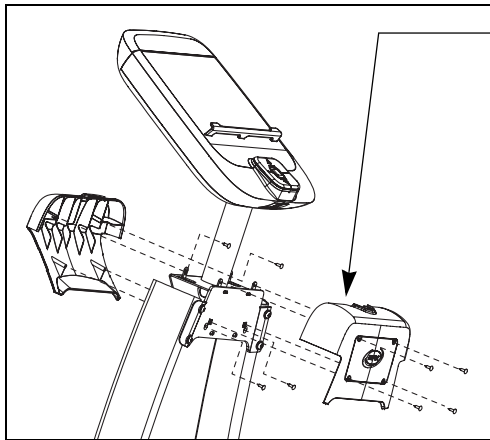

1

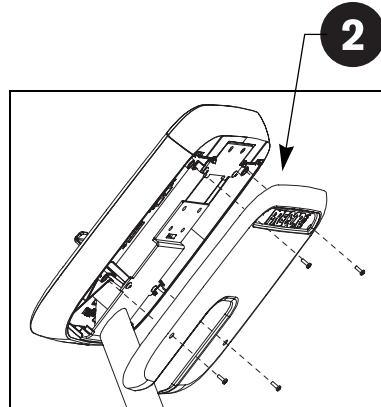

2

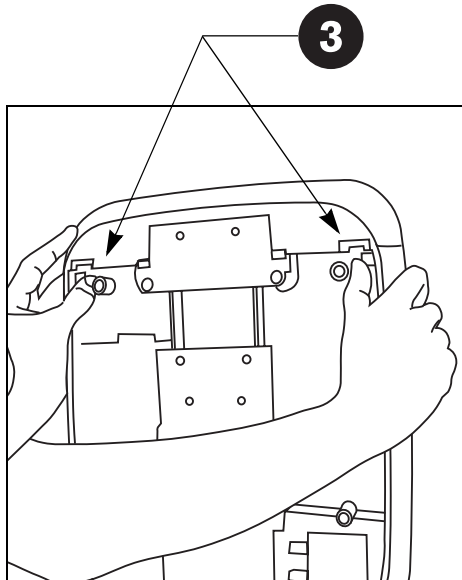

3

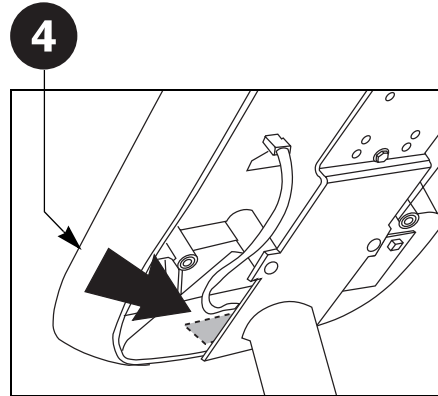

4

To expose the wiring and connections inside the display console and install the PVS, you need to take the following steps:

- 1 Use a Phillips-head screwdriver to remove the eight screws that secure the front and back neck covers. Set the fasteners and covers aside.
- 2 Remove the four screws that secure the back console plate. Set the fasteners and back console plate aside.
- 3 Remove the entertainment option cover. Tabs exist on either side of the cover. Press the tabs to release the cover. You can discard the entertainment option cover.

Important: If you are replacing the integrated receiver, disconnect the 5-wire cable from the display console, and then pull the stereo plug (audio cable) out of the cover before removing and discarding the cover.

- 4 At the base of the display console, remove the audio cover. Place a finger inside the audio cover to push it out of the display console. You can discard the audio cover because it is replaced with the headphone jack.

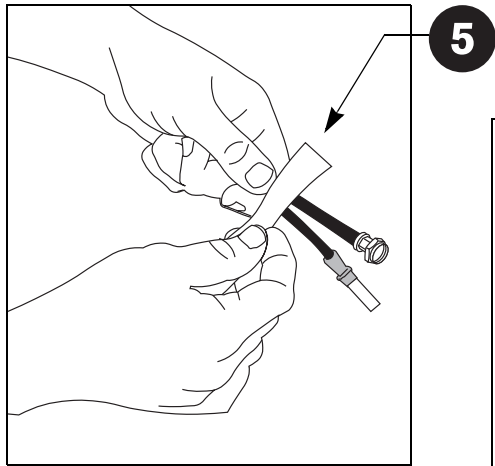

5

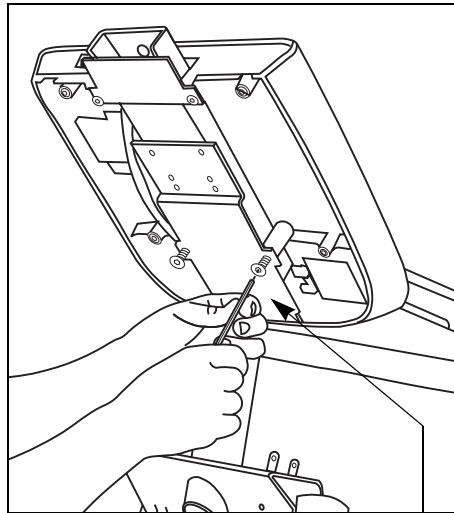

6

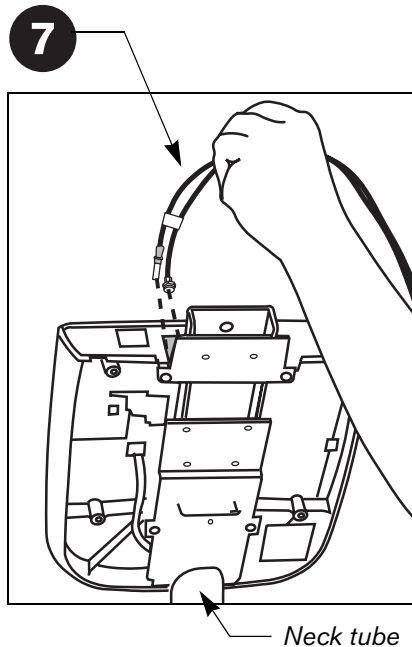

7

Neck tube

Install the Cables

- 5 To make it easier to feed the cables through the unit, tape the ends of the cables together (the female coaxial connection to the power cable). Refer to the illustration.
- 6 Loosen the display console from its bracket by removing the two bottom buttonhead screws using a $\frac{5}{32}$ -inch hex key. This provides access to the EFX neck tube. Set the fasteners aside.

CAUTION: Do not lift the base of the display console too much or you may inadvertently break the upper tabs or damage the display console. Be careful that you do not jostle or damage the heart rate electronics board on the inside of the display console. Cable connections can become dislodged which will impair the heart rate and upper display functions.

- 7 Feed the taped cable ends through the top of the console. Lift the base of the display console and continue to feed the taped cable ends through the neck tube. Let the cables hang.

Note: Leave about 1 foot (30 cm) of cables hanging out of the upper portion of the display console. The coaxial and power connections will be attached to the back of the screen.

- 8 Reattach the display console by inserting the two buttonhead screws removed in step 6 and wrench tighten. Refer to the illustration for step 6.

Important: Make sure that the cables are not pinched between the bracket and the display console.

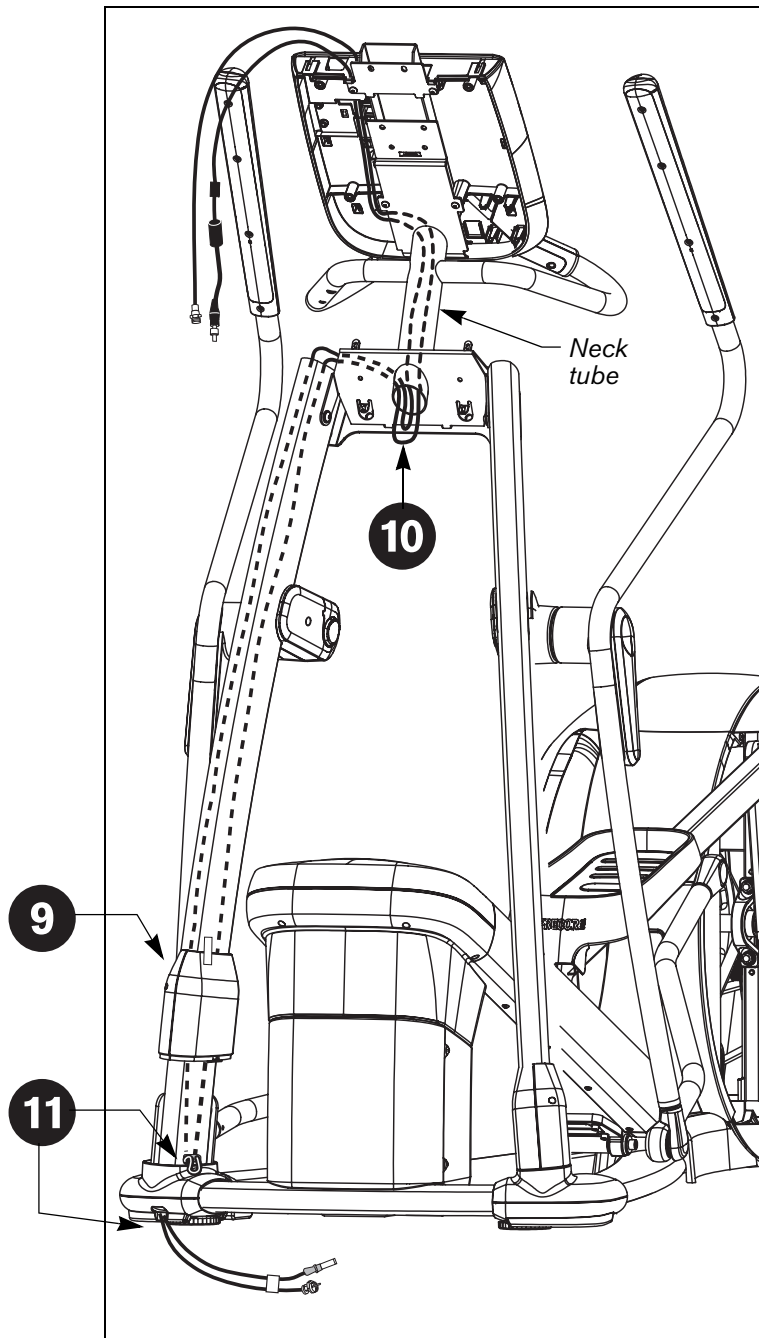

- 9 Remove the two Phillips-head screws that secure the upper boot. Slide the upper boot along the upright support and tape it into place. Refer to the illustration.
- 10 Feed the taped cables back up through the neck tube and out the side hole. Refer to the illustration. Continue to feed the taped cables down through the upright support, following the same route as the existing RJ45 cable.
- 11 Pull the taped cables out of the opening near the base of the unit, and then feed them back through the same opening. Continue feeding the taped cables through the small opening in the lower boot and onto the floor.

Note: You may need to use needle nose pliers to gently pull the cable connectors out the small opening.

Note: This view shows the EFX556i.
The location of the cables is the same for all EFX units.

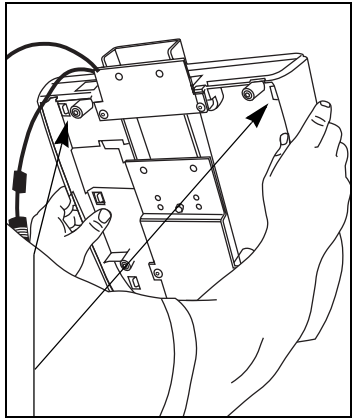

12 Top two tabs first

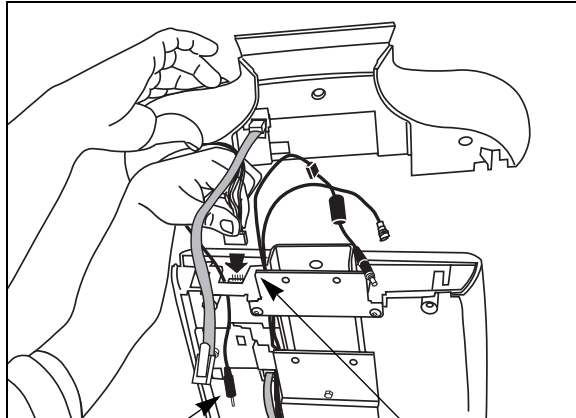

13

14

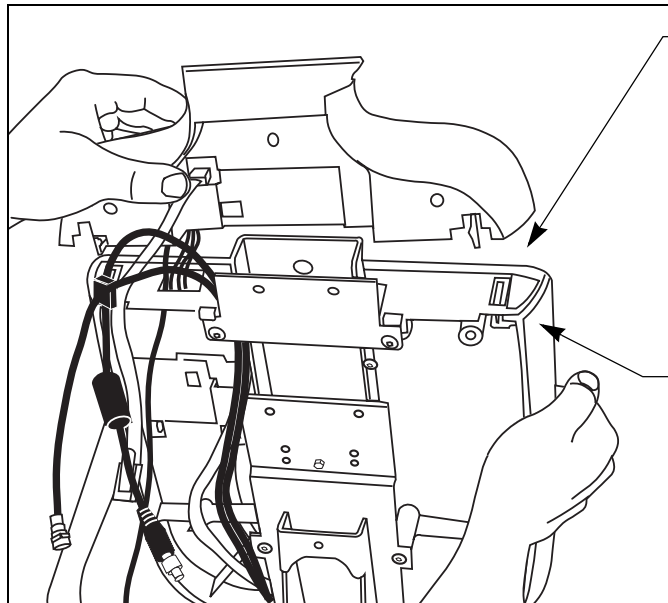

15

16

Attach the Entertainment Option

CAUTION: Do not try to access the tab found beneath the heart rate electronics board.

- 12** Separate the display console face from the console. Start at the top and work toward the bottom, pressing the five tabs to release it. This provides easier access to the 5-pin connector.
- 13** Hold the integrated controller above the display console and feed the audio cable through the opening in the base of the display console. Let the audio cable hang loose.

CAUTION: It is critical that you attach the red wire on the 5-wire entertainment option cable to Pin 1. The word, PIN 1, is inscribed on the back of the display console. An arrow points to the location of Pin 1. The connector is keyed so it will only connect one way. Do not force the connection.

- 14** Connect the 5-wire entertainment option cable to the display console.
- 15** Reattach the display console face by aligning the tabs and applying pressure to the display face.
- 16** Install the integrated controller by aligning the two tabs and applying pressure. Arrange the cables so you do not inadvertently pinch or damage the cables.

Important: Cable damaged by improper installation will not be covered by the Limited Warranty.

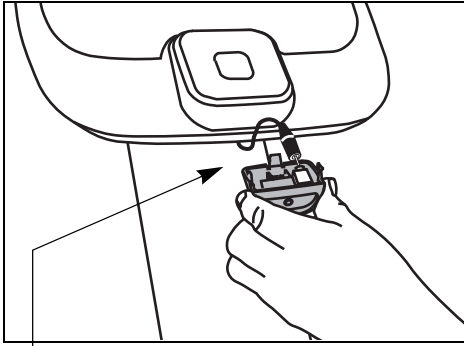

17

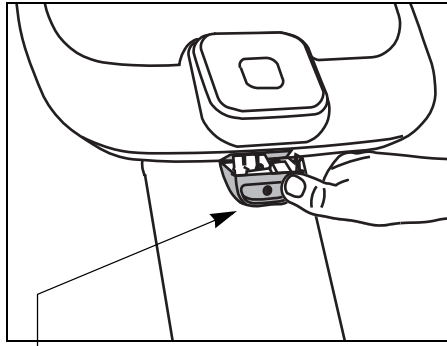

18

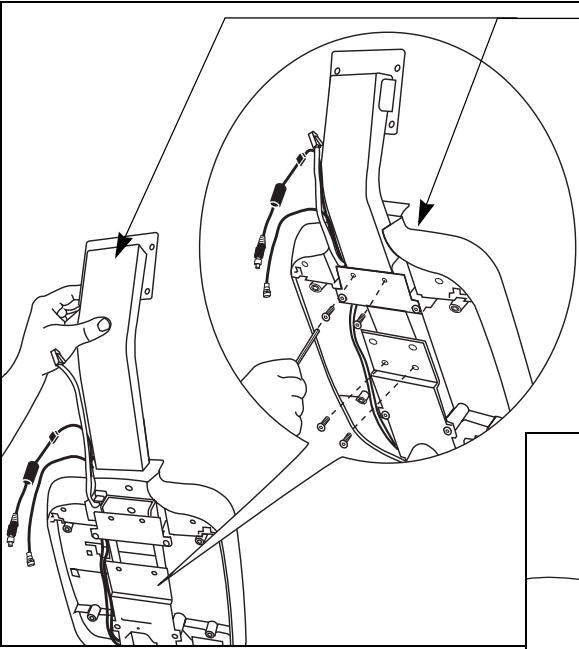

19

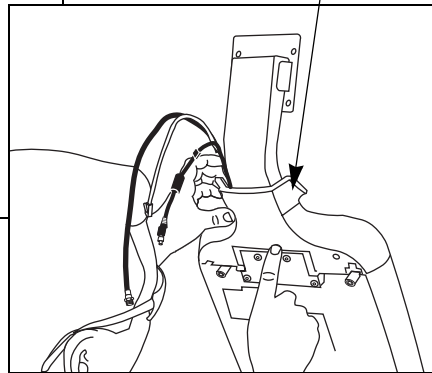

20

- 17 Feed the audio cable through the base of the display console and attach it to the headphone jack.
- 18 Insert the headphone jack into the base of the display console. Snap the headphone jack into place by positioning the rear tab first, and then applying pressure to the base.
- 19 Hold the cables out of the way as you slide the bracket into position and align the four mounting holes. Insert four black buttonhead screws and wrench tighten using a $\frac{5}{32}$ -inch hex key.
- 20 Attach the transition cover. Insert the base of the cover first and apply pressure to the upper portion. It should easily snap it into place.

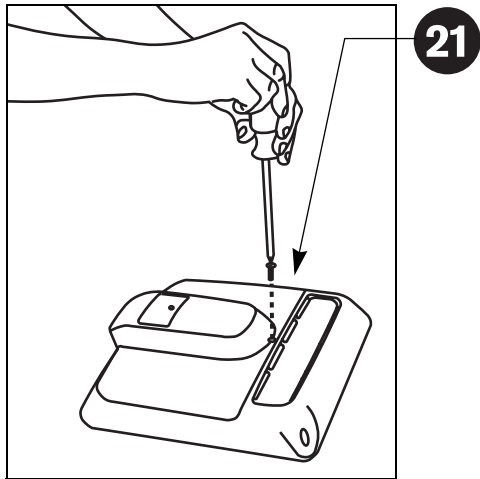

21

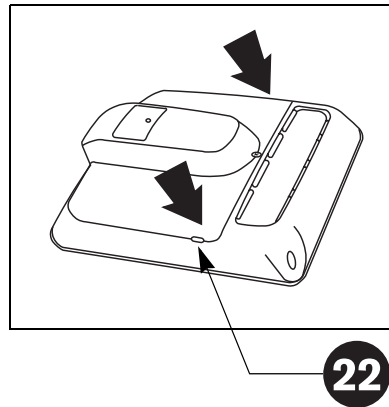

22

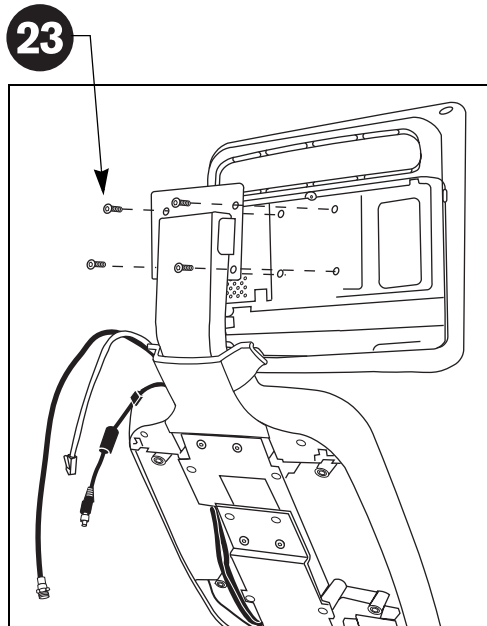

23

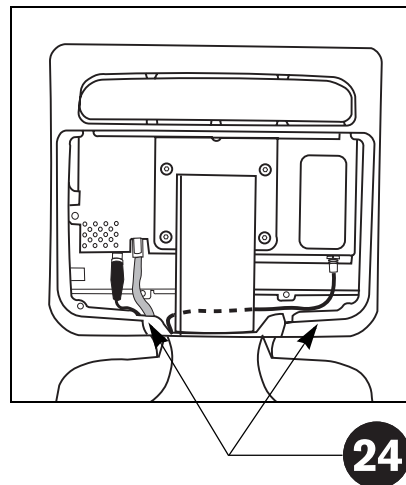

24

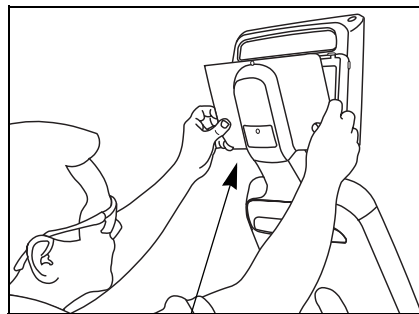

25

Install the Screen

- 21 Place the screen face down on a clean work surface so you have easy access to the back plate. Use a Phillips-head screwdriver to remove the one screw on the back plate.
 - 22 Place your fingers in the finger tabs on opposite sides of the back plate and pull up to remove the back plate. Set the fastener and back plate aside.
 - 23 Move the cables out of the way as you attach the screen to the bracket using four buttonhead screws. Finger tighten and then wrench tighten using a $\frac{5}{32}$ -inch hex key.
 - 24 Plug the RJ45 cable into the back of the screen. Feed the coaxial cable between the back of the screen and the bracket. Connect both the power and coaxial cables to the proper receptacles. Turn the ends of the coaxial and power connectors to properly secure the cables.
 - 25 Replace the back plate. Insert the base tabs first and then, apply pressure to engage the side tabs. Replace the Phillips-head screw. Refer to the illustration for step 21.
- Note:** You may want to test the PVS before replacing the back plate. In this case, perform steps 27 and 28 and then return to steps 25 and 26 to complete the PVS assembly.
- 26 Reassemble the display console by using a Phillips-head screwdriver to reattach the front and back covers (eight screws) and reinstall the back console plate (four screws) removed in steps 1 and 2. Refer to the illustrations shown for steps 1 and 2.

Test the PVS

- 27 At the base of the EFX, plug the power cable to the power extension module and connect it, along with the coaxial cable, into the strip provided for Cardio Theater equipment.
- 28 Observe whether the PVS (screen and integrated controller) is receiving power while you configure the channels using the integrated controller and check the audio connection. For instructions on how to configure channels and troubleshoot the PVS, refer to the *PVS Operation and Maintenance Guide* provided in the box.

Note: A green LED illuminates on the integrated controller when it is connected to a power source.

Precor Treadmill Assembly Steps

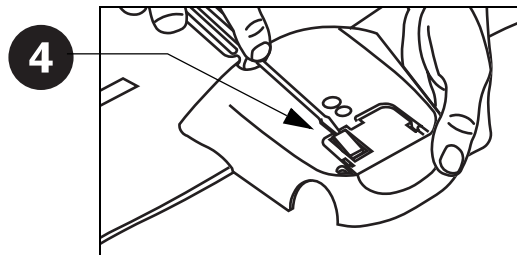
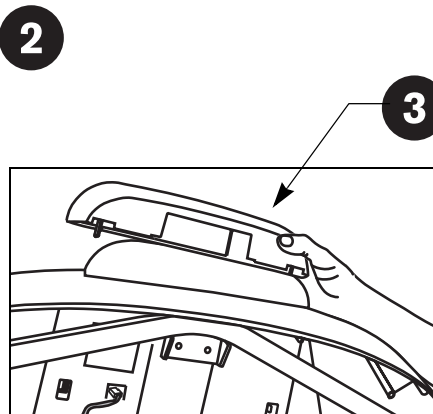
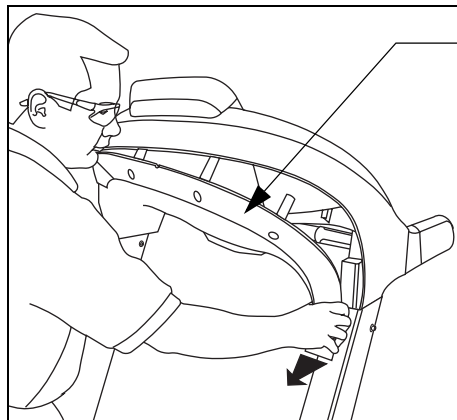
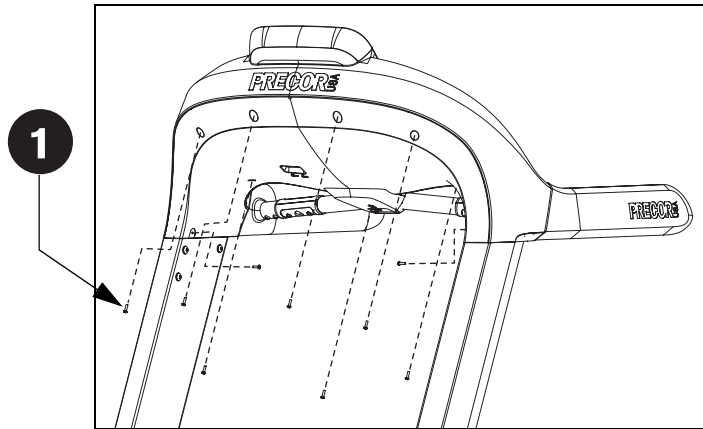

To expose the wiring and connections inside the display console and install the PVS, you need to take the following steps:

CAUTION: Turn OFF the treadmill and unplug it. The ON/OFF (I/O) switch is located on the front of the treadmill beneath the hood overhang.

Important: Unplug any RJ45 connections from the back of the display console cover before removing the cover.

- 1 Use a Phillips-head screwdriver to remove the nine screws that secure the display console back cover. Set the fasteners aside.
- 2 To remove the display console back cover, pull in on one side as you pull the cover down toward the floor. This should flex the cover and enable you to slide it past the fasteners on the upright support.
- 3 Remove the entertainment option cover. Tabs exist on either side of the cover. Press the tabs to release the cover. You can discard the entertainment option cover.
Important: If you are replacing the integrated receiver, disconnect the 5-wire cable from the display console, and then pull the stereo plug (audio cable) out of the cover before removing and discarding the cover.
- 4 At the base of the display console back cover, remove the break away piece to allow room for the audio cable. Use a flathead screwdriver to push the piece out of the display console back cover. You can discard the break away piece.

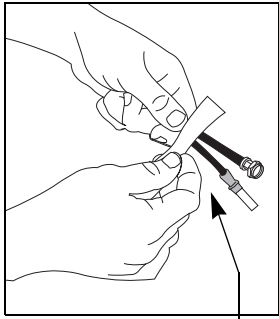

5

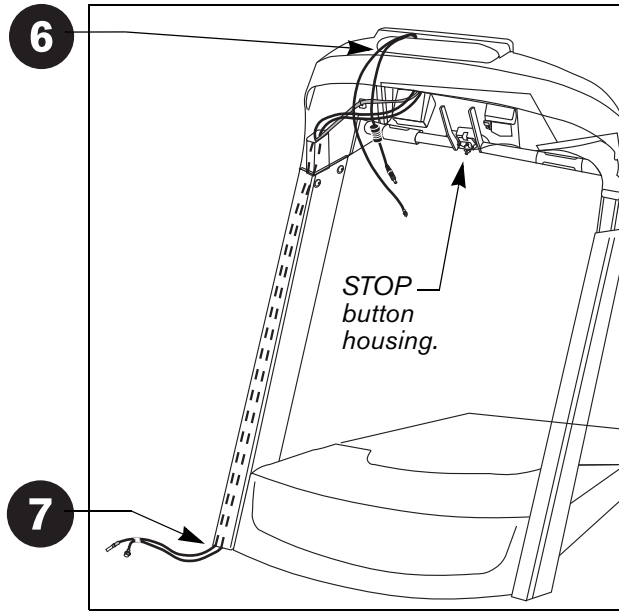

7

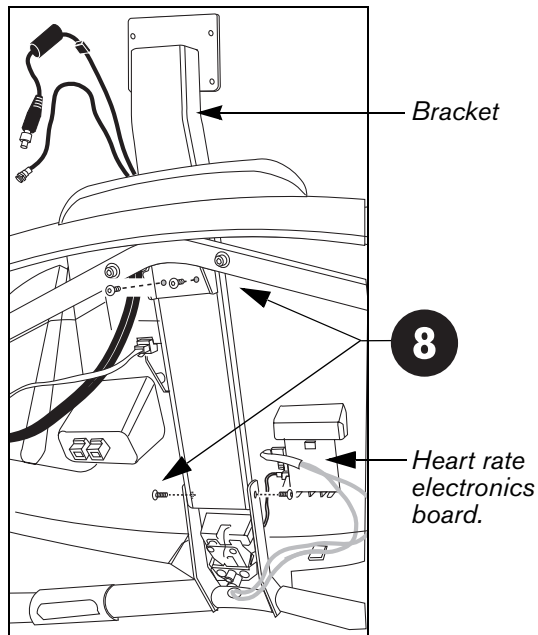

8

Install the Cables and Bracket

5 To make it easier to feed the cables through the unit, tape the ends of the cables together (the female coaxial connection to the power cable). Refer to the illustration.

6 Feed the taped cables through the large, rectangular opening at the top of the display console. Continue to feed the taped cables down through the upright support, following the same route as the existing RJ45 cable.

Note: Leave about 1 foot (30 cm) of cables hanging out of the upper portion of the display console. The coaxial and power connections will be attached to the back of the screen.

7 Pull the taped cables out of the base of the upright support and onto the floor.

CAUTION: Be careful as you slide the bracket into position and align the mounting holes. Avoid sliding the bracket into the STOP button housing as damage can occur to the electronics board.

8 Hold the cables out of the way as you slide the bracket into position and align the two back and two side mounting holes. Insert four black buttonhead screws and wrench tighten using a $\frac{5}{32}$ -inch hex key.

CAUTION: Avoid touching the heart rate cable or the heart rate electronics board. Cable connections can become dislodged which will impair the heart rate and upper display functions. Use the bull-nosed portion of the hex key to tighten the side fasteners.

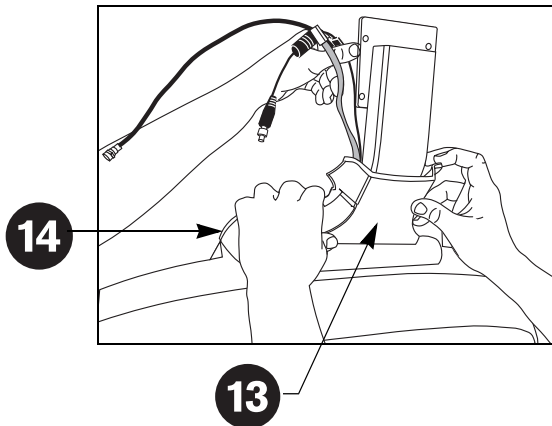
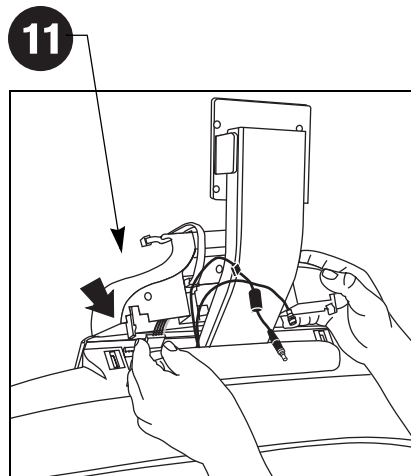
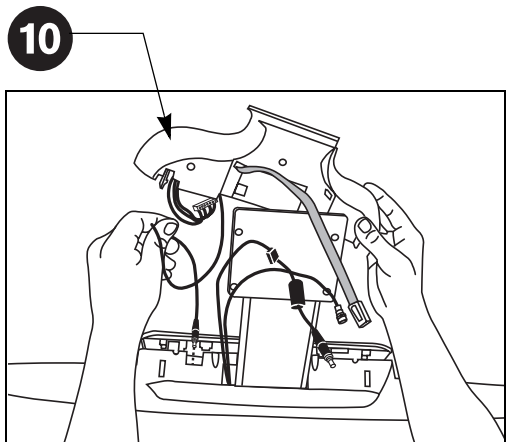
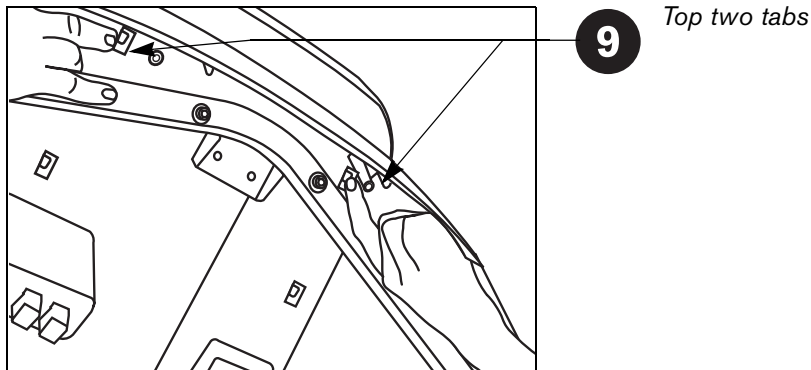

Attach the Entertainment Option

CAUTION: Do not try to access the tab found beneath the heart rate electronics board.

- 9 Separate the display console face from the console. Start at the top and work toward the bottom, pressing the five tabs to release it. This provides easier access to the 5-pin connector.
- 10 Hold the integrated controller above the display console and feed the audio cable through the opening in the base of the display console. Let the audio cable hang loose.

CAUTION: It is critical that you attach the red wire on the 5-wire entertainment option cable to Pin 1. The word, PIN 1, is inscribed on the back of the display console. An arrow points to the location of Pin 1. The connector is keyed so it will only connect one way. Do not force the connection.

- 11 Connect the 5-wire entertainment option cable to the display console.
- 12 Reattach the display console face by aligning the tabs and applying pressure to the display face.

Important: Rest the integrated controller on top of the display console while you realign the cables and install the transition cover. The transition cover must be installed before you can attach the integrated controller.

- 13 Attach the transition cover by inserting the base of the cover first and then applying pressure to the upper portion. It should snap easily into place.
- 14 Install the integrated controller by aligning the two tabs and applying pressure. Arrange the cables so you do not inadvertently pinch or damage the cables.

Important: Cable damaged by improper installation will not be covered by the Limited Warranty.

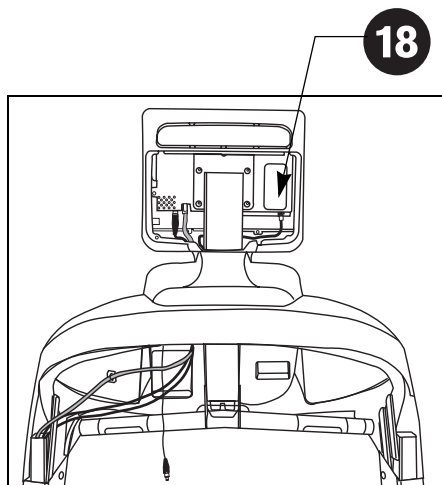
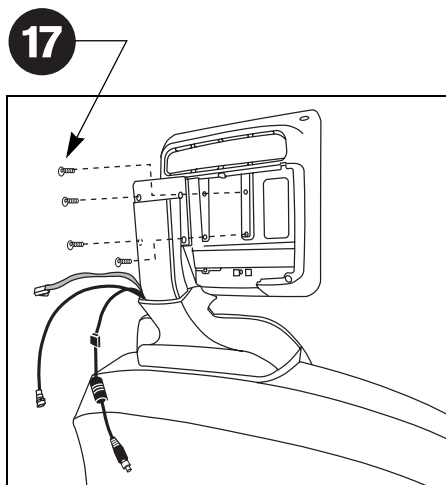
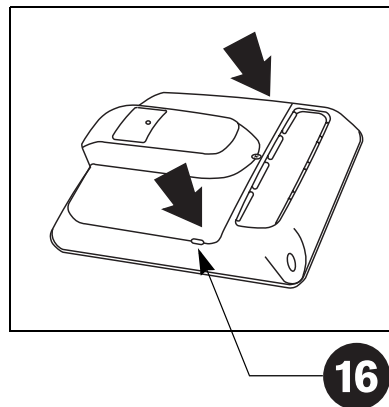
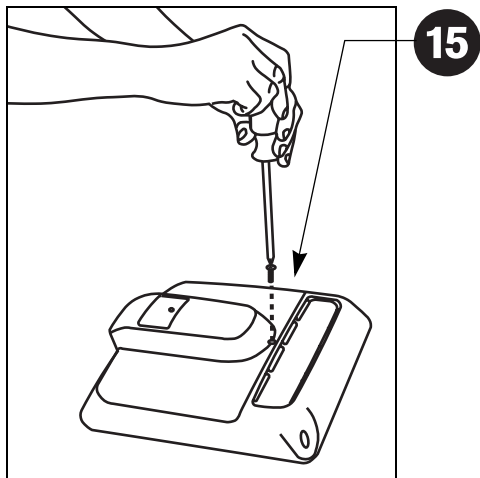

Install the Screen

- 15 Place the screen face down on a clean work surface so you have easy access to the back plate. Use a Phillips-head screwdriver to remove the one screw on the back plate.
- 16 Place your fingers in the finger tabs on opposite sides of the back plate and pull up to remove the back plate. Set the fastener and back plate aside.
- 17 Move the cables out of the way as you attach the screen to the bracket using four buttonhead screws. Finger tighten and then wrench tighten using a $\frac{5}{32}$ -inch hex key.
- 18 Plug the RJ45 cable into the back of the screen. Feed the coaxial cable between the back of the screen and the bracket. Connect both the power and coaxial cables to the proper receptacles. Turn the ends of the coaxial and power connectors to properly secure the cables.

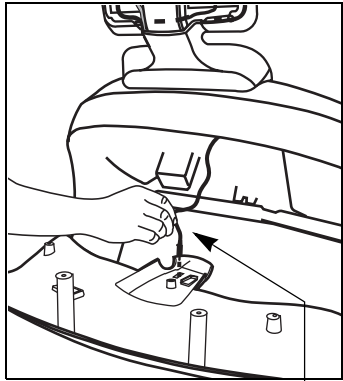

19

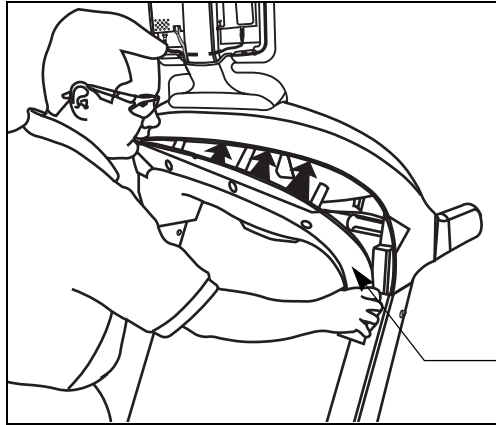

20

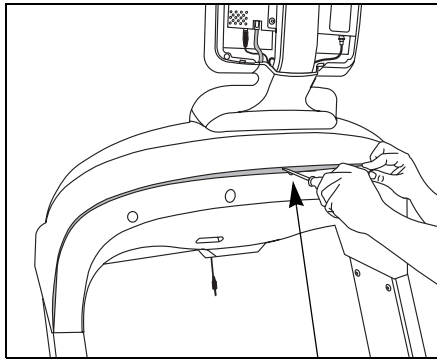

21

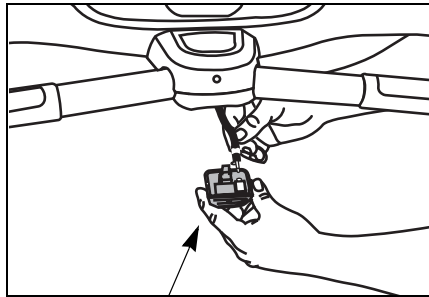

23

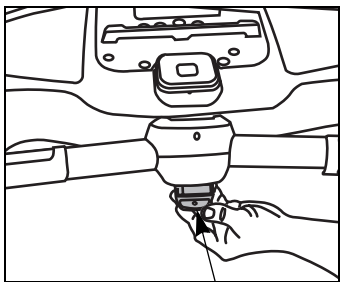

24

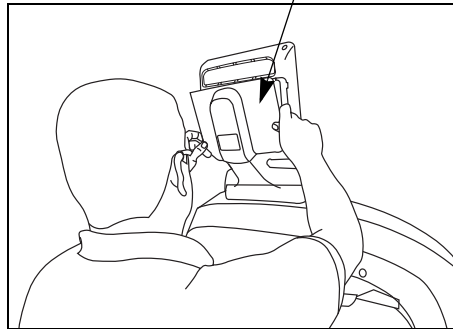

25

Install the Headphone

- 19 Feed the audio cable through the break out in the display console cover.
- 20 Replace the display console back cover by positioning one side above the upright support fasteners. Pull in on the other side to flex the cover which allows you to push it up and slide it past the fasteners on the upright support.
- 21 Use a flat head screwdriver to slide the display console cover under the top console cover.
- 22 Use a Phillips-head screwdriver to reattach the display console back cover with the nine fasteners removed in step 1. Refer to the illustration for step 1.
- 23 Attach the stereo plug to the headphone jack.
- 24 Insert the headphone jack into the base of the display console. Snap the headphone jack into place by positioning the rear tab first, and then applying pressure to the base.
- 25 Replace the back plate. Insert the base tabs first, and then apply pressure to engage the side tabs. Replace the Phillips-head screw. Refer to the illustration for step 15.

Note: You may want to test the PVS before replacing the back plate.

Test the PVS

- 26 At the base of the treadmill, plug the power cable into the power extension module and connect it, along with the coaxial cable, into the strip provided for Cardio Theater equipment.
- 27 Observe whether the PVS (screen and integrated controller) is receiving power while you configure the channels using the integrated controller and check the audio connection. For instructions on how to configure channels and troubleshoot the PVS, refer to the *PVS Operation and Maintenance Guide* provided in the box.

Note: A green LED illuminates on the integrated controller when it is connected to a power source.

Precor Cycle Assembly Steps

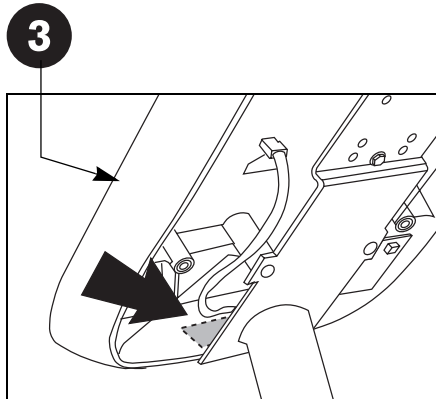
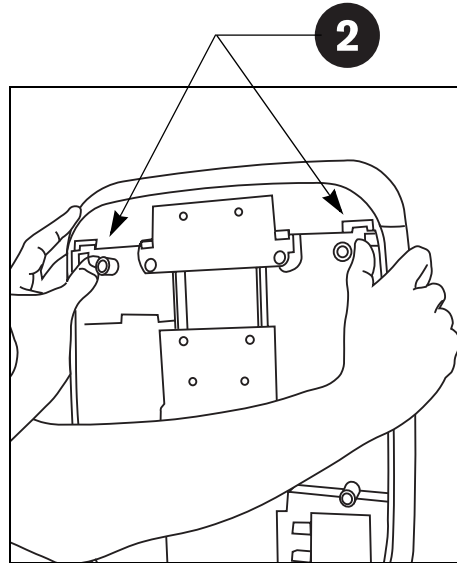
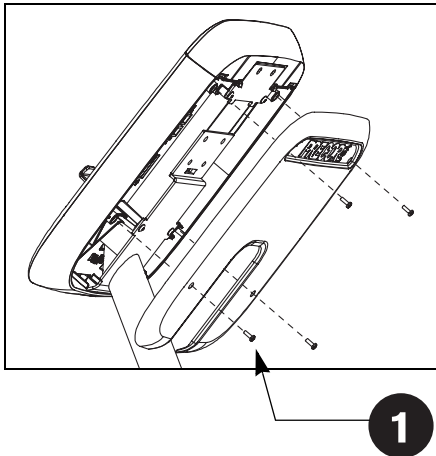

To expose the wiring and connections inside the display console and install the PVS, you need to take the following steps:

- 1 Use a Phillips-head screwdriver to remove the four screws that secure the back console plate. Set the fasteners and back console plate aside.
- 2 Remove the entertainment option cover. Tabs exist on either side of the cover. Press the tabs to release the cover. You can discard the entertainment option cover.

Important: If you are replacing the integrated receiver, disconnect the 5-wire cable from the display console, and then pull the stereo plug (audio cable) out of the cover before removing and discarding the cover.

- 3 At the base of the display console, remove the audio cover. Place a finger inside the audio cover to push it out of the display console. You can discard the audio cover because it is replaced with the headphone jack.

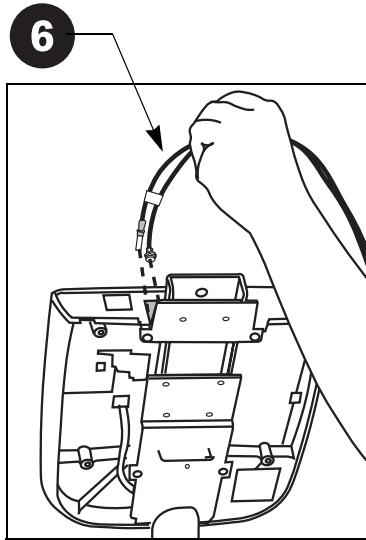
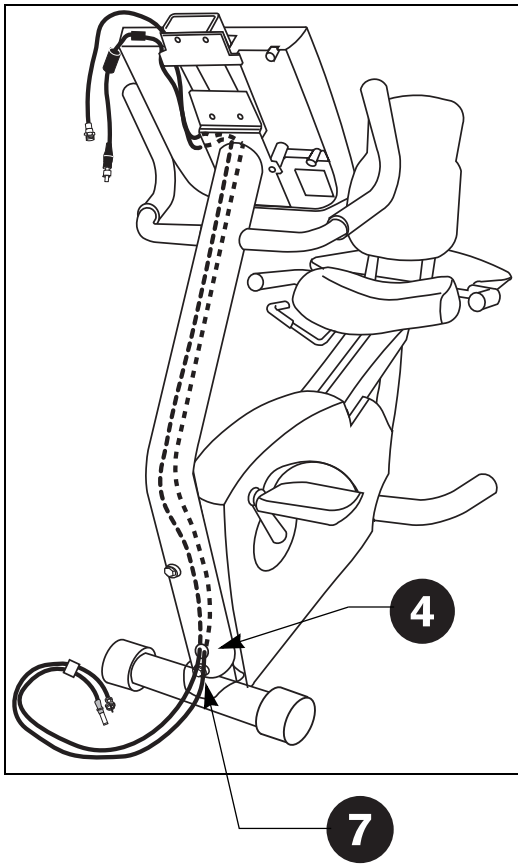
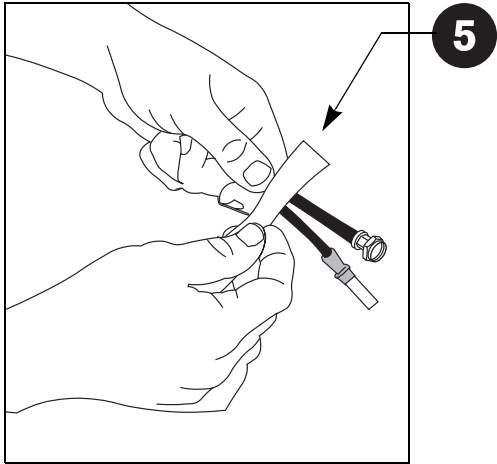

Install the Cables

- 4 At the base of the upright support, remove the rubber plug and discard it.
- 5 To make it easier to feed the cables through the unit, tape the ends of the cables together (the female coaxial connection to the power cable). Refer to the illustration.

CAUTION: Be careful that you do not jostle or damage the heart rate electronics board on the inside of the display console. Cable connections can become dislodged which will impair the heart rate and upper display functions.

- 6 Feed the taped cable ends through the top of the display console, continue to feed the taped cable ends through the upright support and out the hole near its base.

Note: Leave about 1 foot (30 cm) of cables hanging out of the upper portion of the display console. The coaxial and power connections will be attached to the back of the screen.

- 7 Continue to feed the taped ends through the upright support and pull the cables out of the hole near the base of the unit.

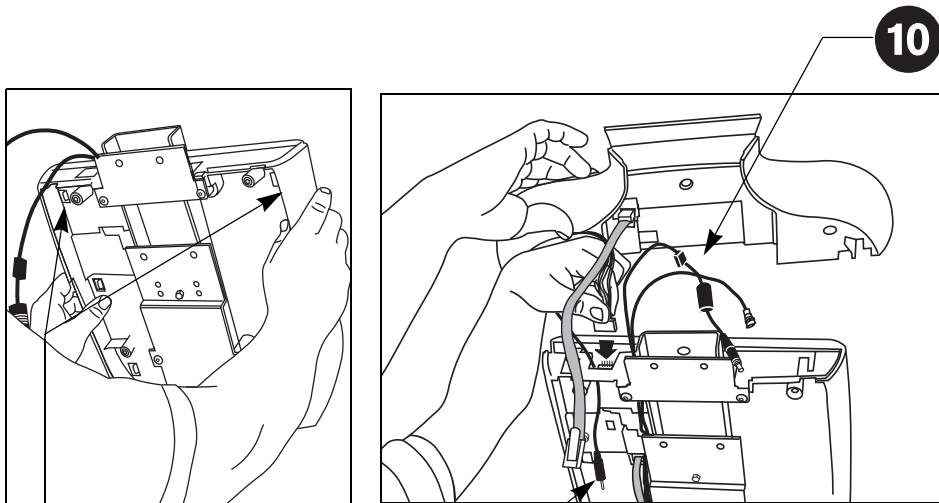

8 Top two tabs

9

10

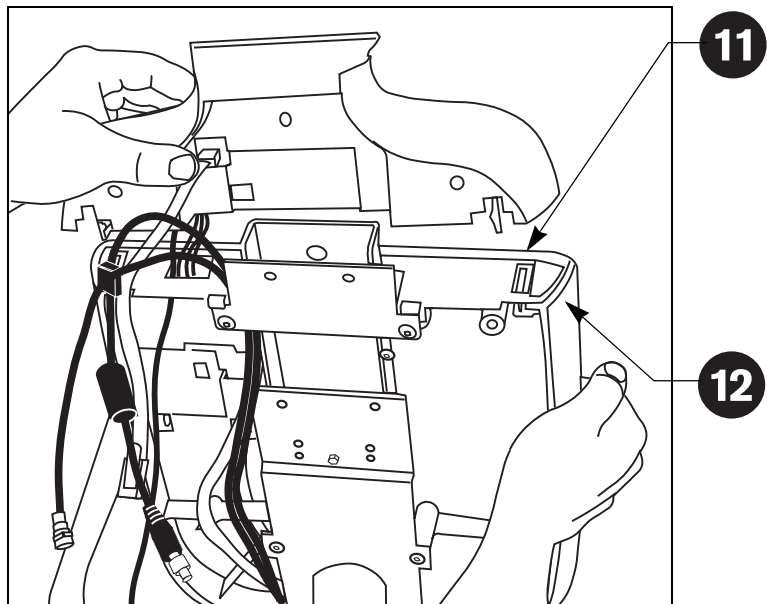

11

12

Attach the Entertainment Option

CAUTION: Do not try to access the tab found beneath the heart rate electronics board.

- 8 Separate the display console face from the console. Start at the top and work toward the bottom, pressing the five tabs to release it. This provides easier access to the 5-pin connector.
- 9 Hold the integrated controller above the display console and feed the audio cable through the opening in the base of the display console. Let the audio cable hang loose.

CAUTION: It is critical that you attach the red wire on the 5-wire entertainment option cable to Pin 1. The word, PIN 1, is inscribed on the back of the display console. An arrow points to the location of Pin 1. The connector is keyed so it will only connect one way. Do not force the connection.

- 10 Connect the 5-wire entertainment option cable to the display console.
- 11 Reattach the display console face by aligning the tabs and applying pressure to the display face.
- 12 Install the integrated controller by aligning the two tabs and applying pressure. Arrange the cables so you do not inadvertently pinch or damage the cables.

Important: Cable damaged by improper installation will not be covered by the Limited Warranty.

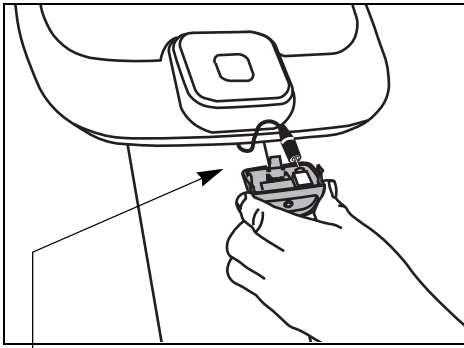

13

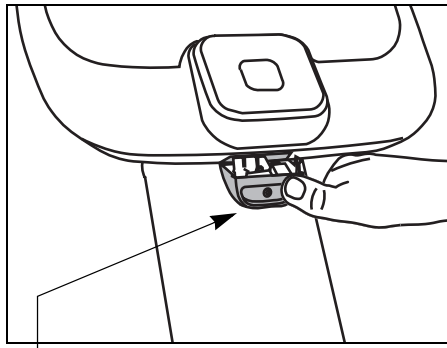

14

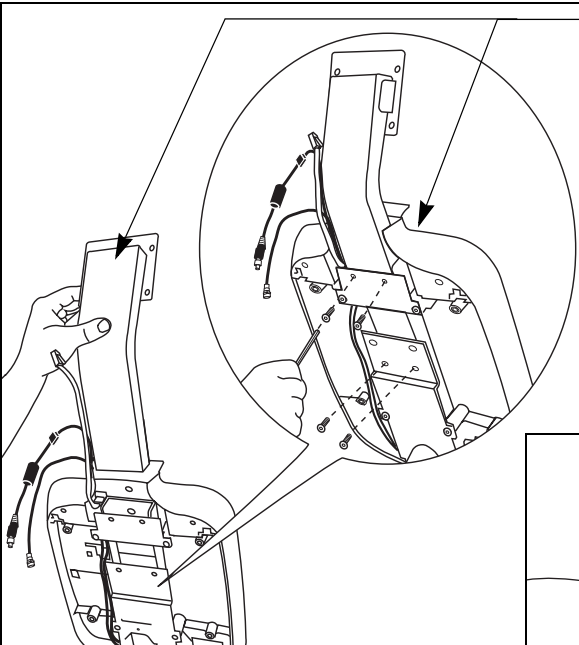

15



16

- 13 Feed the audio cable through the base of the display console and attach it to the headphone jack.
- 14 Insert the headphone jack into the base of the display console. Snap the headphone jack into place by positioning the rear tab first, and then applying pressure to the base.
- 15 Hold the cables out of the way as you slide the bracket into position and align the four mounting holes. Insert four black buttonhead screws and wrench tighten using a $\frac{5}{32}$ -inch hex key.
- 16 Attach the transition cover. Insert the base of the cover first and apply pressure to the upper portion. It should easily snap it into place.

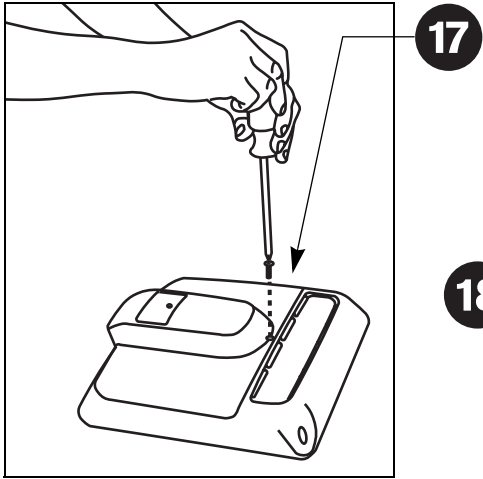

17

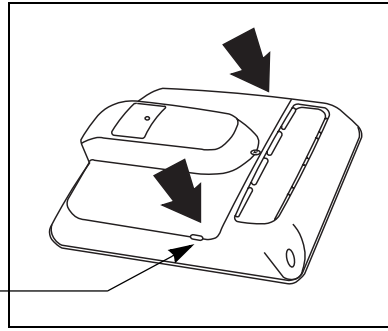

18

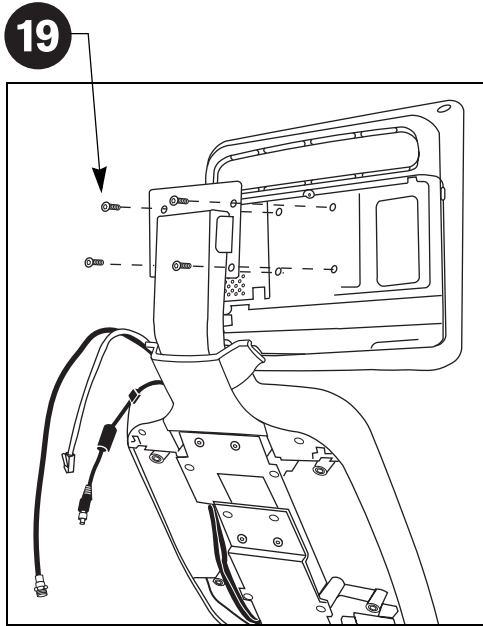

19

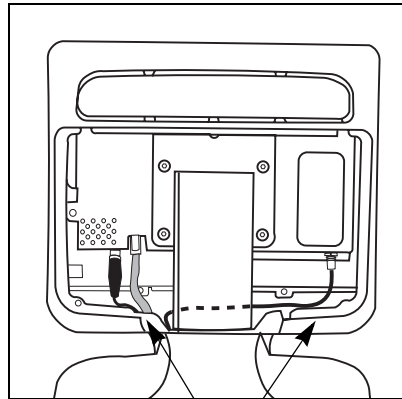

20

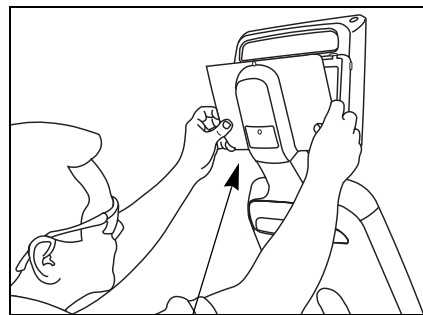

21

Install the Screen

- 17 Place the screen face down on a clean work surface so you have easy access to the back plate. Use a Phillips-head screwdriver to remove the one screw on the back plate.
 - 18 Place your fingers in the finger tabs on opposite sides of the back plate and pull up to remove the back plate. Set the fastener and back plate aside.
 - 19 Move the cables out of the way as you attach the screen to the bracket using four buttonhead screws. Finger tighten and then wrench tighten using a $\frac{5}{32}$ -inch hex key.
 - 20 Plug the RJ45 cable into the back of the screen. Feed the coaxial cable between the back of the screen and the bracket. Connect both the power and coaxial cables to the proper receptacles. Turn the ends of the coaxial and power connectors to properly secure the cables.
 - 21 Replace the back plate. Insert the base tabs first and then, apply pressure to engage the side tabs. Replace the Phillips-head screw. Refer to the illustration for step 17.
- Note:** You may want to test the PVS before replacing the back plate. In this case, perform steps 23 and 24 and then return to steps 21 and 22 to complete the PVS assembly.
- 22 Reassemble the display console by using a Phillips-head screwdriver to reattach the back console plate (four screws) removed in step 1. Refer to the illustration in step 1.

Test the PVS

- 23 At the base of the cycle, plug the power cable into the power extension module and connect it, along with the coaxial cable, into the strip provided for Cardio Theater equipment.
- 24 Observe whether the PVS (screen and integrated controller) is receiving power while you configure the channels using the integrated controller and check the audio connection. For instructions on how to configure channels and troubleshoot the PVS, refer to the *PVS Operation and Maintenance Guide* provided in the box.

Note: A green LED illuminates on the integrated controller when it is connected to a power source.

Notes

Notes



A Division of Precor Incorporated
20031 142nd Ave NE
Woodinville, WA USA 98072-4002

Cardio Theater, EFX, and Precor are registered trademarks and Cardio Theater PVS and Cardio Theater Quick Change Headphone Jack are trademarks of Precor Incorporated.
Copyright 2006 Precor Incorporated.
www.cardiotheater.com

NOTICE:

Due to continuing advancements in technology, Precor Incorporated reserves the right to make changes in hardware, packaging, and any accompanying documentation without prior written notice.

PVS Assembly Guide CX30383-101
Warranty Statement CX30037-101
24 March 2006